

SPE infeed

SPE16/3x7/700 (1200), SPE16/1x7-14/700 (1200)



Assembly instructions

Preparation and instructions for installation of the SPE infeed

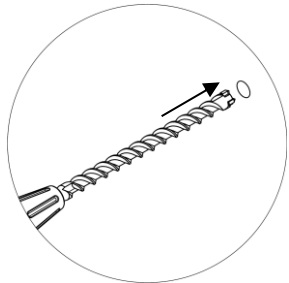

Building exterior:

- From the outside of the building, drill a hole with a diameter of 25 mm using a hammer drill and masonry drill bit.
- Clean the hole.
- If necessary, repair any break-outs, which are not covered by the flange of the external sealing element and rework the seal on the external wall.

Assembling the SPE infeed

Attention! Remove protective foil from the blue sealing tape of the SPE infeed!

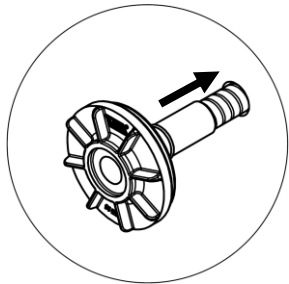

Building exterior:

- From the building exterior, feed the flexible protective hose of the SPE infeed into the hole.
- Press the external sealing element into the hole, until the blue sealing tape sits against the wall right round.

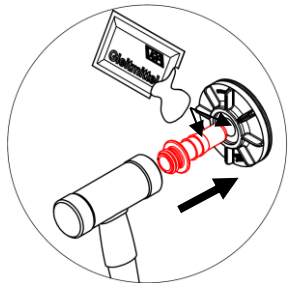

- Lubricate the internal sealing element and external clamping sleeve and carefully knock in the sealing element with a soft-faced hammer, until the clamping sleeve flange lies in the intended recess in the sealing element.

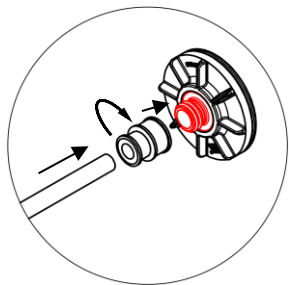

- Fit the rubber seal on the clamping sleeve by turning it; when doing so make sure the ribs in the clamping sleeve sit in the grooves in the rubber seal intended for this.
- Feed in the speed-pipe protection tubes.

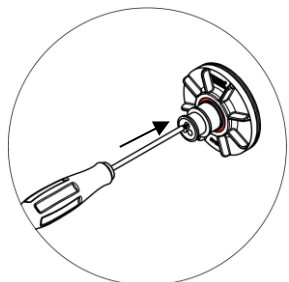

- Pierce the rubber seal 3 x 7 mm for the required number of speed-pipe protection tubes using a Phillips screwdriver and feed in the speed-pipe protection tubes.

SPE infeed

SPE16/3x7/700 (1200), SPE16/1x7-14/700 (1200)



Assembly instructions

Building interior:

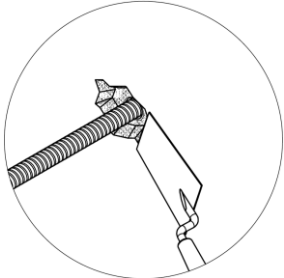

- Repair break-outs that are not covered by the flange of the inner cover.

Attention:

Do not reduce drill hole diameter (\varnothing 25 mm) through rework!

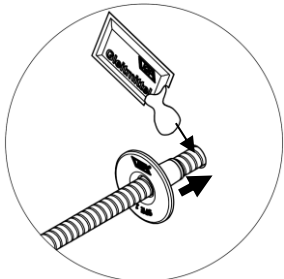

- Lubricate flexible protective hose and slide inner cover, support side first, over the protective hose into the hole until the flange lies fully against the wall.

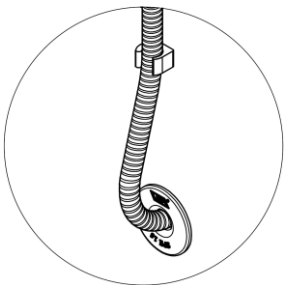

- Shorten flexible protective hose according to requirement and fasten to the wall as required after laying the speed-pipe protection tubes.

It is necessary to ensure that the pipes/cables to be connected exhibit no damage in the area of the seal.

It is necessary to ensure that no tensile/pressure forces and mechanical loads act on the pipes/cables to be connected, and on the penetration.

Important note:

We accept no warranty claims in case of deviations from the information in the assembly instructions and/or with incorrect use of our products.

This also applies to combinations with external products that have not been approved by us.

General:

Observe the nationally valid installation and filling specifications of the pipe manufacturer!

Compact the substrate and cable foundation well before cable/pipe installation, so that the cables/pipes cannot sink.

Incorrect cable or protection pipe installation and unprofessional filling of the cable trench leads to settling, which can in turn lead to damage.

Only open cable penetrations directly before fitting with cables, in order to avoid unintentional damage during structural work.

You find assembly instructions in other languages on the side www.uga.eu or on inquiry!